

Dimensions du panneau pour mesure du cylindre

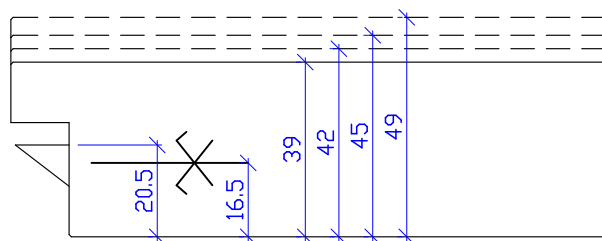

- 39mm = Porte communication type: RSP + VSP + MSP
- 42mm = Porte EI30 type: GB100 - A + 42I - A (porte EI30 s-sol)
- 45mm = Porte EI30 type: 1E - 45I - A (porte EI30 s-sol ou palière)
- 49mm = Porte EI30 type: 49I - A + 49MI - MA (porte palière)

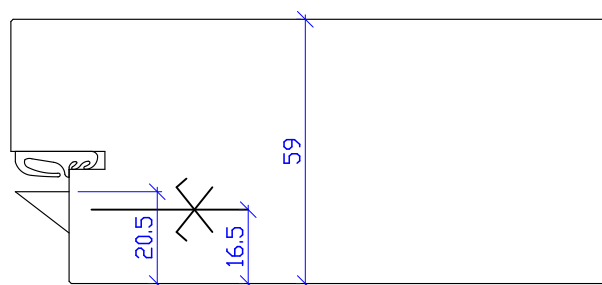

- 59mm = Porte EI30 type: 59I - A + 59MI - MA (porte palière)

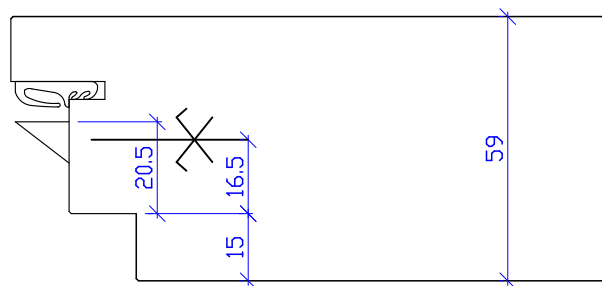

- 59mm = Porte EI30 type: 59I - A + 59MI - MA (porte palière avec battue 15x15mm)